



68J100

Flanged ANSI 300 API STANDARD 608 stainless steel A351-CF8M ball valve, full bore, ASME B16.10 face to face dimension, Fire Safe, Antistatic Device.

Technical specifications

Drawing

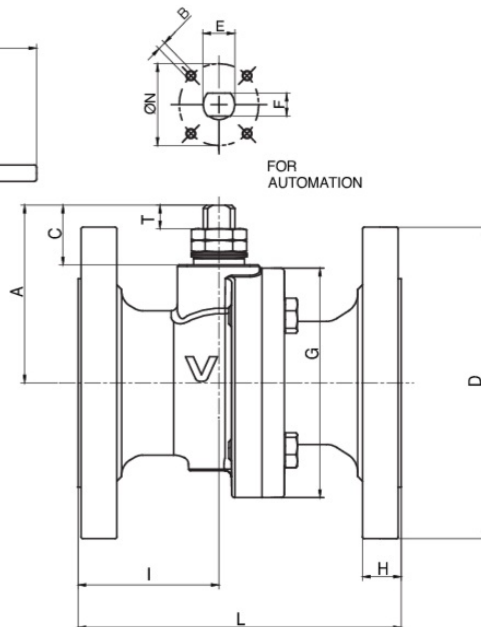
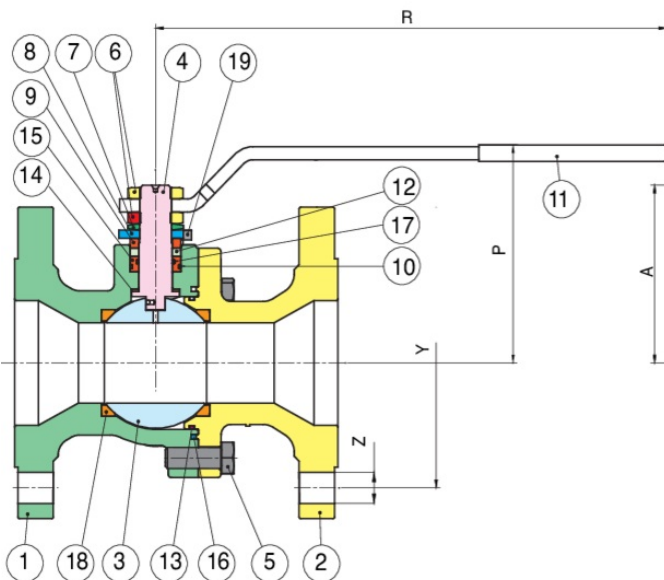
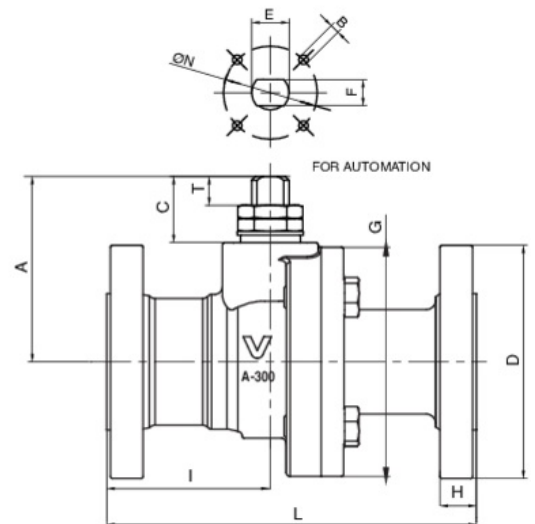
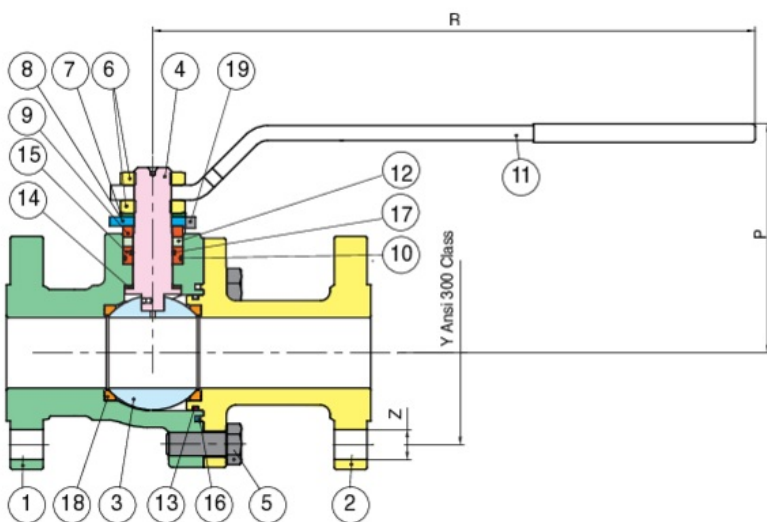

Materials

POSITION	PART NAME	MATERIAL	N.° PIECES
1	BODY	A351-CF8M	1
2	END CONNECTION	A351-CF8M	1
3	BALL	A479-TP316	1
4	STEM	A564-TP630 H115OD (17-4-PH)	1
5	SCREW	A193 B8 CL.2	4-6-8
6	NUT	STAINLESS STEEL	2
7	SPRING WASHER	A182-F304	2
8	90° STOP	AISI 316	1
9	BUSH	A479-TP316L	1
10	O-RING	FKM (VITON)	1
11	HANDLE	AISI 316	1
12	STEM SEAL	GRAFITE	1
13	O-RING	FKM (VITON)	1
14	THRUST WASHER	RPTFE	1
15	O-RING BUSH	A479-TP316L	1
16	BODY SEAT	GRAFITE	1
17	O-RING	FKM (VITON)	1
18	BALL SEAT	RPTFE	2
19	SCREW	A2-70	2

Table

CODE	SIZE	DN	D	Y	Z	H	I	L	G	P	R	A	C	T	E	F	ØN	B	KV	PN	KG
68J100-1	1"	-	-	-	-	-	-	-	-	-	-	-	-	-	-	-	-	-	-	-	-
68J100-1-1/2	1 1/2"	-	-	-	-	-	-	-	-	-	-	-	-	-	-	-	-	-	-	-	-
68J100-1/2	1/2"	-	-	-	-	-	-	-	-	-	-	-	-	-	-	-	-	-	-	-	-
68J100-2	2"	-	-	-	-	-	-	-	-	-	-	-	-	-	-	-	-	-	-	-	-
68J100-3	3"	-	-	-	-	-	-	-	-	-	-	-	-	-	-	-	-	-	-	-	-
68J100-3/4	3/4"	-	-	-	-	-	-	-	-	-	-	-	-	-	-	-	-	-	-	-	-
68J100-4	4"	-	-	-	-	-	-	-	-	-	-	-	-	-	-	-	-	-	-	-	-
68J100-6	6"	-	-	-	-	-	-	-	-	-	-	-	-	-	-	-	-	-	-	-	-
68J10004	1/2"	15	95	66.7	4	14.7	62.7	140	82	95	174	54	21.5	6.8	M12	8	42	M5	19.2	50	3.1
68J10005	3/4"	20	115	82.6	4	16.3	67	152	90	99	174	58	21	6.8	M12	8	42	M5	35	50	4.5
68J10006	1"	25	125	88.9	4	17.9	70.5	165	105	100	250	74.8	29	9.5	M16	10	50	M6	64.5	50	6.4
68J10008	1"1/2	40	155	114.3	4	21.1	104	190	128	123	321	99	35.5	15.5	M20	14	50	M6	174	50	11.6
68J10010	2"	50	165	127	8	23	90	216	140	133	321	109	37	16.5	M20	14	50	M6	301.3	50	14.4
68J10014	3"	80	210	168.3	8	29	122	282	188	167	381	150	44.5	20.5	M24	18	102	M10	872.5	50	32
68J10061	3"x2"	80x50	210	168.3	8	29	138	282	140	133	321	109	36.5	16.5	M20	14	50	M6	146	50	22.1
68J10018	4"	100	255	200	8	32.2	128	305	235	186	610	167	42	18.5	M24	18	102	M10	1363.3	50	52.4
68J10064	4"x3"	100x80	255	200	8	32.2	135	305	188	167	381	150	44.5	20	M24	18	102	M10	418	50	41.6
68J10020	6"	150	320	269.9	12	37	200.5	403	322	-	-	245	64	37.5	M42	30	125	M12	3671.1	50	109
68J10074	6"x4"	150x100	320	269.9	12	37	196	403	235	186	610	167	42	18.5	M24	18	102	M10	754	50	74.6

Notes

Gear operator included

Locking device available

Available spare parts

Temperature range: -20° +180°

Vacuum: 10-3 torr.

Low temperature design -45°C ON REQUEST

Certifications

SIL 3

| FIRE-SAFE Acc. EN ISO
10497/API 607

| ATEX |

F.E. TESTED ISO15848-1