

68F000

Flanged ANSI 150 API STANDARD 608 zinc-plated carbon steel A352-LCC ball valve, full bore, ASME B16.10 face to face dimension, Fire Safe, Antistatic Device.

Technical specifications

Drawing

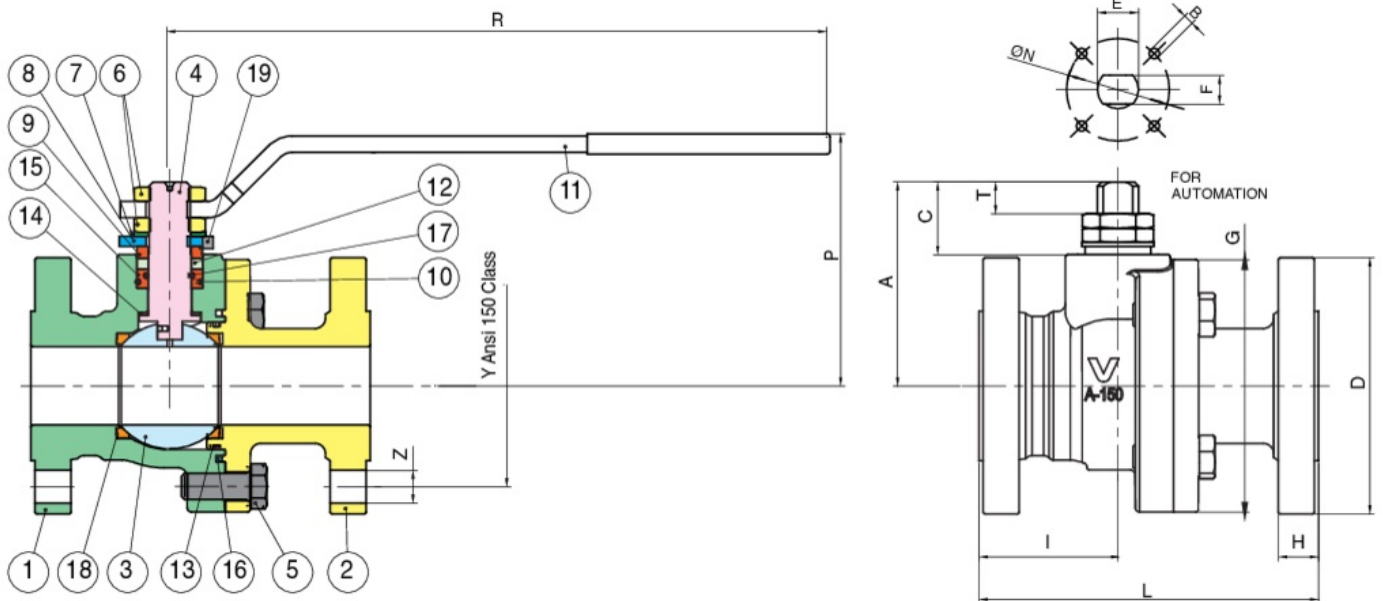

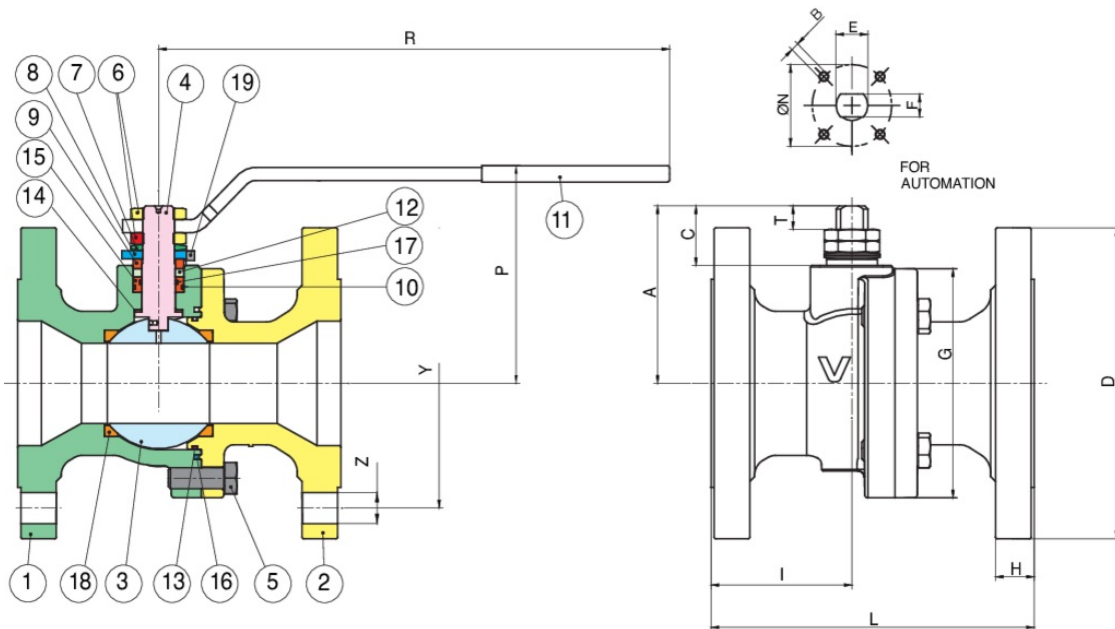

Materials

POSITION	PART NAME	MATERIAL	N.° PIECES
1	BODY	A352-LCC	1
2	END CONNECTION	A352-LCC	1
3	BALL	A479-TP316	1
4	STEM	A564-TP630 H1150D (17-4-PH)	1
5	SCREW	A320 L7	4-6-8
6	NUT	CARBON STEEL	2
7	SPRING WASHER	CARBON STEEL	2
8	90° STOP	AISI 316	1
9	BUSH	A479-TP316L	1
10	O-RING	FKM (VITON)	1
11	HANDLE	CARBON STEEL	1
12	STEM SEAL	GRAFITE	1
13	O-RING	FKM (VITON)	1
14	THRUST WASHER	RPTFE	1
15	O-RING BUSH	A479-TP316L	1
16	BODY SEAT	GRAFITE	1
17	O-RING	FKM (VITON)	1
18	BALL SEAT	RPTFE	2
19	SCREW	CARBON STEEL	2

Table

CODE	SIZE	DN	D	Y	Z	H	I	L	G	P	R	A	C	T	E	F	ØN	B	KV	PN	KG
68F000-1	1"	-	-	-	-	-	-	-	-	-	-	-	-	-	-	-	-	-	-	-	-
68F000-1-1/2	1 1/2"	-	-	-	-	-	-	-	-	-	-	-	-	-	-	-	-	-	-	-	-
68F000-1/2	1/2"	-	-	-	-	-	-	-	-	-	-	-	-	-	-	-	-	-	-	-	-
68F000-2	2"	-	-	-	-	-	-	-	-	-	-	-	-	-	-	-	-	-	-	-	-
68F000-3	3"	-	-	-	-	-	-	-	-	-	-	-	-	-	-	-	-	-	-	-	-
68F000-3/4	3/4"	-	-	-	-	-	-	-	-	-	-	-	-	-	-	-	-	-	-	-	-
68F000-4	4"	-	-	-	-	-	-	-	-	-	-	-	-	-	-	-	-	-	-	-	-
68F000-6	6"	-	-	-	-	-	-	-	-	-	-	-	-	-	-	-	-	-	-	-	-
68F00004	1/2"	15	90	60.3	4	11.6	45.5	108	82	95	174	54	21.5	6.8	M12	8	42	M5	19.2	20	2.4
68F00005	3/4"	20	100	69.9	4	13.5	48.5	117	90	99	174	58	21	6.8	M12	8	42	M5	35	20	3.3
68F00006	1"	25	110	79.4	4	14.7	53	127	105	100	250	74.7	29	9.5	M16	10	50	M6	64.5	20	4.81
68F00008	1 1/2"	40	125	98.4	4	18	94.5	165	123	123	321	100	35.5	15.5	M20	14	50	M6	174	20	8.7
68F00010	2"	50	150	120.5	4	19.5	76	178	140	133	321	108.5	36.5	16.5	M20	14	50	M6	301.3	20	11.9
68F00014	3"	80	190	152.4	4	24.3	82	203	188	167	381	149.5	44.5	20.5	M24	18	70	M8	872.5	20	24.1
68F00061	3"x2"	80x50	210	168.3	8	29	138	282	140	133	321	109	36.5	16.5	M20	14	50	M6	146	50	22.1
68F00018	4"	100	230	190.5	8	24.3	90	229	235	186	381	167	42.5	18.5	M24	18	102	M10	1363.3	20	38.5

CODE	SIZE	DN	D	Y	Z	H	I	L	G	P	R	A	C	T	E	F	ØN	B	KV	PN	KG
68F00064	4"x3"	100x80	255	200	8	32.2	135	305	188	167	381	150	44.5	20	M24	18	102	M10	418	50	41.6
68F00020	6"	150	280	241.3	8	26	241	394	315	-	-	245	68	41	M42	30	125	M12	3671.1	20	85.8
68F00074	6"x4"	150x100	320	269.9	12	37	196	403	235	186	610	167	42	18.5	M24	18	102	M10	754	50	74.6

Notes

Temperature range: -20° +180°

Vacuum: 10-3 torr.

Gear operator included

Locking device available

Low temperature design -45°C ON REQUEST

Certifications

SIL 3

| FIRE-SAFE Acc. EN ISO
10497/API 607

| ATEX

F.E. TESTED ISO15848-1