

703000

Full bore stainless steel AISI 316-CF8M ball valve, F/F threading, ISO 5211, direct mount pad Antistatic Device.

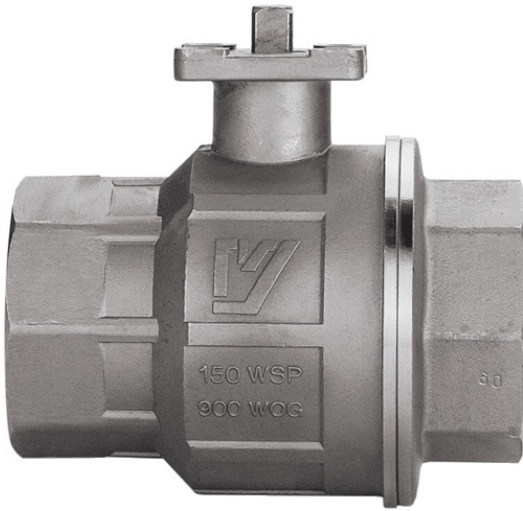

Technical specifications

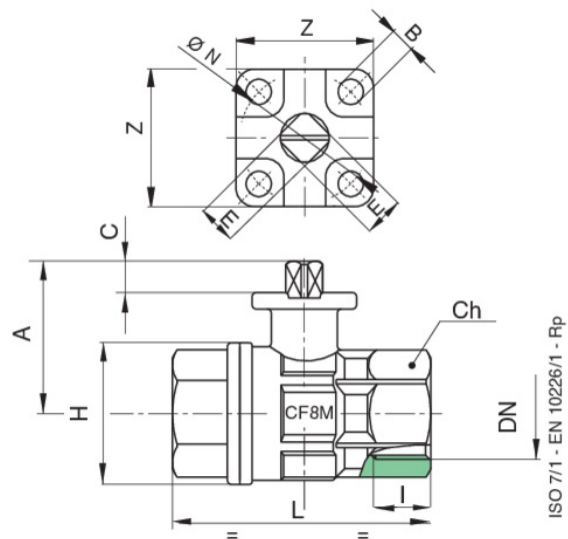
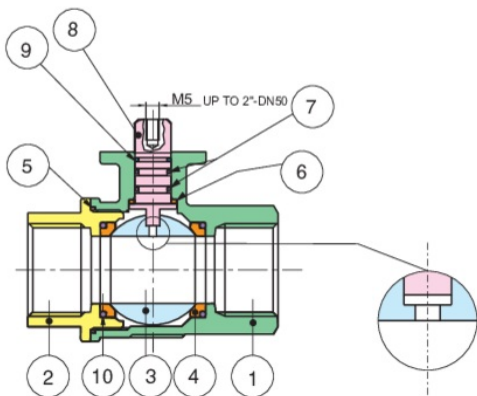

Temperature range: -20° $+160^{\circ}$

Vacuum: 10^{-2} torr.

POSITION	PART NAME	MATERIAL	N.° PIECES
1	BODY	A351-CF8M	1
2	END CONNECTION	A351-CF8M	1
3	BALL	A479-TP316/A351-CF8M	1
4	BALL SEAT	PTFE	2
5	SEAT	PTFE	1
6	THRUST WASHER	PTFE	1
7	O-RING	FKM	2
8	STEM	A479-TP316/17-4-PH	1
9	STEM SEAT	PTFE	1
10	O-RING (1/2"-2")	FKM	2

SIZE	DN	CODE	BOX	I	L	H	CH	A	C	E	ØN	B	Z	KV	PN	KG
1/2"	15	70300004	10	15	67	34,5	ES.27	41,5	9	9	36	6	38	19,2	64	0,30
3/4"	20	70300005	6	16,3	78	42	ES.32	43,5	9	9	36	6	38	35	64	0,40
1"	25	70300006	5	19,1	90	51,5	ES.41	53,5	9	9	36	6	38	64,5	64	0,70
1"1/4	32	70300007	2	21,4	100	64,5	OT.50	57	9	9	36	6	38	103,8	64	1,04
1"1/2	40	70300008	2	21,4	112	77	OT.55	74	11	11	50	7	50	174	64	1,68
2"	50	70300010	3	25,7	135	97	OT.70	83,3	11	11	50	7	50	301,3	64	2,95
2"1/2	65	70300012	1	30,2	160	124	87	111	15,5	14	70	9	64	545,7	25	6,06
3"	80	70300014	1	33,3	180	145	105	120	17,5	14/17	70	9	64	872,5	25	9,50

Certifications



ATEX



SIL 3

Spare Parts

● HANDLES

Code	Material	Size
RI2012	AISI 430	1/8"
RI2012	AISI 430	1/4"
RI2012	AISI 430	3/8"
RI2012	AISI 430	1/2"
RI2013	AISI 430	3/4"
RI2014	AISI 430	1"
RI2014	AISI 430	1"1/4
RI2015	AISI 430	1"1/2
RI2015	AISI 430	2"
RI2016	A 37	2"1/2
RI2016	A 37	3"
RI2017	A 37	4"
RI2179	AISI 316	1/8"
RI2179	AISI 316	1/4"
RI2179	AISI 316	3/8"
RI2179	AISI 316	1/2"
RI2180	AISI 316	3/4"
RI2181	AISI 316	1"
RI2181	AISI 316	1"1/4
RI2182	AISI 316	1"1/2
RI2182	AISI 316	2"
RI2183	AISI 316	2"1/2
RI2183	AISI 316	3"
RI2184	AISI 316	4"

● **POLISHED HANDLES**

Code	Material	Size
RI2022	AISI 316	1/8"
RI2022	AISI 316	1/4"
RI2022	AISI 316	3/8"
RI2022	AISI 316	1/2"
RI2023	AISI 316	3/4"
RI2024	AISI 316	1"
RI2024	AISI 316	1"1/4
RI2025	AISI 316	1"1/2
RI2025	AISI 316	2"
RI2026	AISI 316	2"1/2
RI2026	AISI 316	3"
RI2027	AISI 316	4"

● **BUTTERFLY HANDLES**

Code	Material	Size
RI2028	AISI 430	1/8"
RI2028	AISI 430	1/4"
RI2028	AISI 430	3/8"
RI2028	AISI 430	1/2"

● SEATS

Code	Material	Size
RI421	PTFE	1/8"
RI421	PTFE	1/4"
RI421	PTFE	3/8"
RI422	PTFE	1/2"
RI423	PTFE	3/4"
RI424	PTFE	1"
RI427	PTFE	1"1/4
RI425	PTFE	1"1/2
RI426	PTFE	2"
RI2174	PTFE	2"1/2
RI2176	PTFE	3"
RI2031	PTFE	4"
RI2054	PTFE VETRO - GLASS FILLED PTFE	1/8"
RI2054	PTFE VETRO - GLASS FILLED PTFE	1/4"
RI2054	PTFE VETRO - GLASS FILLED PTFE	3/8"
RI2055	PTFE VETRO - GLASS FILLED PTFE	1/2"
RI2056	PTFE VETRO - GLASS FILLED PTFE	3/4"
RI2057	PTFE VETRO - GLASS FILLED PTFE	1"
RI2058	PTFE VETRO - GLASS FILLED PTFE	1"1/4
RI2059	PTFE VETRO - GLASS FILLED PTFE	1"1/2
RI2060	PTFE VETRO - GLASS FILLED PTFE	2"
RI2175	PTFE VETRO - GLASS FILLED PTFE	2"1/2
RI2177	PTFE VETRO - GLASS FILLED PTFE	3"
RI2034	PTFE VETRO - GLASS FILLED PTFE	4"
RI2148	PTFE CARBOGRAFITE - CARBON FILLED PTFE	1/8"
RI2148	PTFE CARBOGRAFITE - CARBON FILLED PTFE	1/4"
RI2148	PTFE CARBOGRAFITE - CARBON FILLED PTFE	3/8"
RI2149	PTFE CARBOGRAFITE - CARBON FILLED PTFE	1/2"
RI2150	PTFE CARBOGRAFITE - CARBON FILLED PTFE	3/4"
RI2151	PTFE CARBOGRAFITE - CARBON FILLED PTFE	1"
RI2152	PTFE CARBOGRAFITE - CARBON FILLED PTFE	1"1/4
RI2153	PTFE CARBOGRAFITE - CARBON FILLED PTFE	1"1/2
RI2154	PTFE CARBOGRAFITE - CARBON FILLED PTFE	2"
RI2155	PTFE CARBOGRAFITE - CARBON FILLED PTFE	2"1/2
RI2156	PTFE CARBOGRAFITE - CARBON FILLED PTFE	3"
RI2157	PTFE CARBOGRAFITE - CARBON FILLED PTFE	4"
RI2204	PTFE	1/2"
RI2205	PTFE	3/4"
RI2206	PTFE	1"
RI2207	PTFE	1"1/4
RI2208	PTFE	1"1/2
RI2209	PTFE	2"
RI2951	PTFE	3"

● **BALL**

Code	Material	Size
00301000002	AISI 316	1/8"
00301000002	AISI 316	1/4"
00301000002	AISI 316	3/8"
00304000037	AISI 316	1/2"
00305000031	AISI 316	3/4"
00306000031	AISI 316	1"
00307000028	AISI 316	1"1/4
00308000025	AISI 316	1"1/2
00310000079	AISI 316	2"
00312000009	AISI 316	2"1/2
00314000013	AISI 316	3"
00318007006	AISI 316	4"
00304000078	AISI 316	1/2"
00305000035	AISI 316, AISI 304	3/4"
00306000082	AISI 316	1"
00307000031	AISI 316	1"1/4
00308000026	AISI 316	1"1/2
00310000080	AISI 316	2"
00314000013	AISI 316	3"

● **STEMS**

Code	Material	Size
00401000003	AISI 316	1/8"
00401000003	AISI 316	1/4"
00401000003	AISI 316	3/8"
00401000003	AISI 316	1/2"
00405000029	AISI 316	3/4"
00406000011	AISI 316	1"
00406000011	AISI 316	1"1/4
00408000010	AISI 316	1"1/2
00408000010	AISI 316	2"
00412000021	AISI 316	2"1/2
00412000021	AISI 316	3"
00418000021	AISI 316	4"
00401000003	AISI 316	1/8"
00401000003	AISI 316	1/4"
00401000003	AISI 316	3/8"
00401000003	AISI 316	1/2"
00405000029	AISI 316	3/4"
00406000011	AISI 316	1"
00406000011	AISI 316	1"1/4
00408000010	AISI 316	1"1/2
00408000010	AISI 316	2"
00412000021	AISI 316	2"1/2
00412000021	AISI 316	3"
00404000028	AISI 316	1/2"
00404000028	AISI 316	3/4"
00406000010	AISI 316	1"
00406000010	AISI 316	1"1/4
00408000009	AISI 316	1"1/2
00408000009	AISI 316	2"
00414000023	AISI 316	3"

● **STEMS ANTISTATIC DEVICE**

Code	Material	Size
00418000006	AISI 316	4"